

043-4126 EC, CONTRA ANGLE SHEATH  
 043-2542 E4R, CONTRA ANGLE SHEATH

Operation Manual

135°C : AUTOCLAVABLE

OM-CZ490E 003

**⚠ Caution before use**

- The number one priority is the safety of all patients.
- If an abnormality occurs during use, stop immediately. Report this to the Patterson branch where it was purchased.
- Do not disassemble or alter the sheath.
- Do not drop the sheath onto a hard surface.
- Always watch for vibration, sound, temperature rise, bur wobble and other abnormalities.
- Disconnect the sheath after the driver unit has completely stopped.
- The device accepts Patterson® heads.
- Do not wipe with, clean or immerse in highly acidic water or sterilizing solutions.

### 1. Specifications

Product number	EC (043-4126)	E4R (043-2542)
Allowable max. speed	40,000 rpm	40,000 rpm
Speed reduction ratio	1 : 1	4 : 1

### 2. Installation/Removal of Head onto/from Contra Angle Sheath

Align the Clutch of the head with that of the sheath. Then install the head onto the sheath, turning the Union Nut counterclockwise with your fingers.

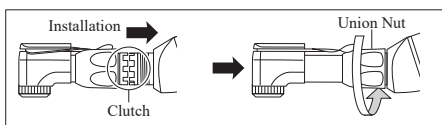

**⚠ Caution**

- Never use the attachment if it cannot be smoothly installed onto or removed from the straight nosecone or the contra angle sheath. **In such a case, consult the Patterson Service Center.**

### 3. Cleaning and Drying

#### Cleaning and Drying the Exterior

The use of automated cleaning devices is not recommended for the cleaning of Contra Angle Sheaths.

Wash the handpiece under running water following the procedures below. (Water condition: ≤100°F, ≥3.5L/min; water should be of the same quality as drinking water)

- Clean the external surfaces of the handpiece with a soft bristled toothbrush for 15 seconds or more.
- Clean around the bur insertion hole for 15 seconds or more, using an interdental brush (wire thickness 0.7mm) that conforms to size 4 in ISO 16409.

Under appropriate lighting (natural office lighting, 500 lx or higher), inspect the handpiece for blood or other debris. If any visible debris remains, repeat the process until the handpiece is visually clean.

After cleaning, if the residual moisture is present, wipe off with dry cloth or blow it off with compressed air (≤50.75psi) until there is no moisture in the interior and exterior.

When blowing off with compressed air, cover the handpiece with cloth to prevent scattering of water. Proceed to 4: Cleaning and Lubrication.

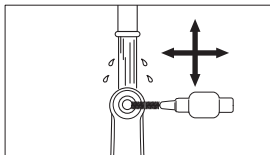
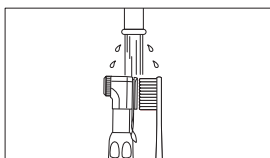

### 4. Cleaning and Lubrication

#### Cleaning and Lubricating the Interior

- Attach an E-Type spray nozzle to the nozzle of the PANA SPRAY Plus.
- Shake the can 3 or 4 times and insert the E-Type spray nozzle into the rear of the handpiece while holding the head of the handpiece with a cloth etc.
- Hold the handpiece and spray for 2 or 3 seconds until oil comes out of the handpiece head. Repeat lubrication until foreign material stops coming out of the tip.

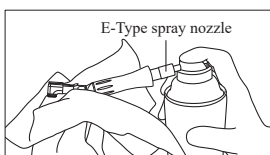



## Caution

- Do not use sprays other than PANA SPRAY Plus. Using sprays other than PANA SPRAY Plus may cause the handpiece to overheat.
- Hold the spray can upright.
- Firmly hold the handpiece to prevent it slipping when spray pressure is applied.
- Spray lubricant until it expels from the handpiece head.
- If you wish to purge excessive oil from inside the handpiece, rotate the handpiece for approx 15 seconds without a bur. During the rotation, do not depress the push button, especially when using absorbent cloth to prevent oil from scattering. Depressing the push button during rotation may damage the chuck mechanism.

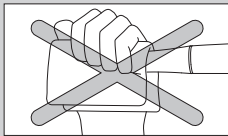
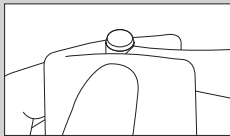

## 5. Sterilization

### Autoclaving is recommended for sterilization.

Sterilization is required the first time you use it and after each patient, as noted below.

- Before sterilization, clean the surface of the attachment and lubricate the attachment (refer to instruction 3: Cleaning and Drying and 4: Cleaning and Lubrication).
- Put the attachment into a sterilization pouch by itself.
- Place the attachment in the center or upper shelf of the autoclave chamber.
- Autoclave the handpiece at 135°C/275°F for 20 minutes.



## Caution

- Never use dry heat sterilization, cold sterilization, etc.
- Never autoclave the attachment with other instruments in the same sterilization pouch.
- Never place the attachment at the bottom of the autoclave chamber, as the temperature at the bottom may rise above the actual setting temperature.
- Do not wipe with, clean or immerse in highly acidic water or sterilizing solutions.

## 6. Guarantee

Patterson guarantees the head for six months and the sheath for six months, subject to observance of maintenance instructions, cautions, warnings and normal use.

### Note:

- Patterson reserves the right to analyze and determine the cause of any failure.
- Guarantee is void if the breakage, accident or any other issues are caused by the neglect of daily maintenance, cautions, warnings or common sense in use.
- Dismantling or reassembling by any third party other than the Patterson Service Center, except for the replacement of the head, the replacement of the cartridge and the disassembling instructions for lubrication, voids the guarantee.

## 7. Symbol



This product can be sterilized in a steam sterilizer at 135°C.



HIBCC DataMatrix for Unique Device Identifier.

*Pour une version en français du manuel d'utilisation, veuillez vous rendre sur le site Web de Patterson: <https://www.pattersondental.com/fr-CA>*

Manufactured for:

Fabriqué pour :

Patterson Dental Supply, Inc.  
1031 Mendota Heights Road  
Saint Paul, MN 55120

2022-11-24 CACCXXXX XXN